

**AGENDA
DRAINAGE DISTRICT 56
LANDOWNER MEETING
MARCH 28, 2018 AT 10:00 A.M.**

1. Open Meeting
2. Approve Agenda
3. Attendance/Introductions
4. Explanation Of Landowner Request

Documents:

[DD 56 WO 204 MAP ZOOMED OUT.PDF](#)
[DD 56 WO 204 MAP ZOOMED IN.PDF](#)
[DD 56 WO 204 WORK ORDER REQUEST.PDF](#)

5. Comments/Discussion
6. Possible Action
7. Other Business
8. Adjourn Meeting

D.D. No. 123
(D.D. 26)

Tipton Creek

Tipton Creek

D.D. No. 26

5

4

3

D.D. No. 56

FJELLAND'S
SUB.
8722-C

D.D.
No.
55: Div #2

D.D. No. 152

D.D. No. 152

D.D. No.
55: Div #2

8

9

10

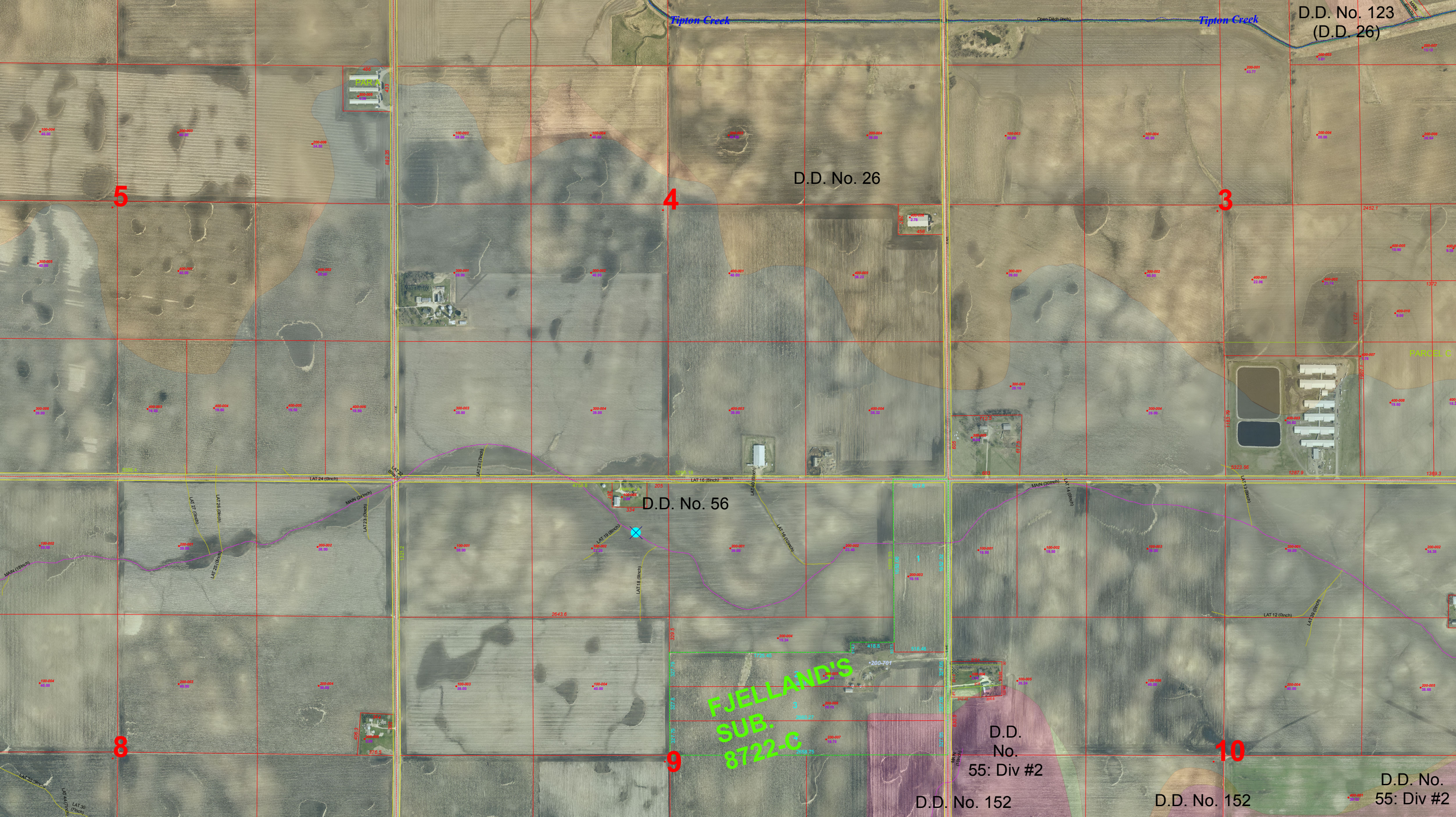



LAT 24 (0Inch)

LAT 22 (5Inch)

LAT 21 (7Inch)

230th ST.

5295.18

LAT 16 (8Inch)

LAT 40 (6Inch)

MAIN (24Inch)

LAT 23 (0Inch)

4758.8

MAIN (24Inch)

205

PARCELA
100-005
1.03
334

LAT 16 (10Inch)

200-002
38.00

100-001
38.00

100-002
37.20

200-001
39.00

MAIN (30Inch)

D.D. No. 56 2643.6

LAT 18 (9Inch)

329.5

200-004
15.24

1725.45

200-004
36.00

100-003
39.00

100-004
40.00

327.79

2

200-005
20.24

406.3

343
392
200-005
3.00
376.5

327.8

3

200-006
19.75

2680.27

327.79

4

200-007
19.75

2658.75

9.

FJELLAND'S
SUB.
8722-C



Drainage Work Order Request For Repair

Hardin County

Date 3/1/2018 Work Order # 204
District # 56 Lateral _____ Fund # 51087
Township Sherman Section 9 Twp 87 Rge 22 Qtr Sec NW1/4

Repair Requested By Lynn Holechek
Address lynn.holechek@gmail.com Phone (515) 460-1425

Landowner same
Address _____ Phone _____

Request Taken By Tina Schlemme

Available for Repair Now? Yes Date Available _____

Problem Description

Lynn would like more drg capacity for his land. Sheldahl Bros believe it best to sever the tile west of E Ave & annex into DD 26 to drain to Tipton Creek. The land east of E Ave, that's flat, would benefit from not taking all the water from the west.	

Repair labor, materials and equipment _____

Potential Wetlands? Yes-Repair existing tile only No-Repair and maintain tile

Repaired By: _____

Date: _____

Please send statement for services to:
Phone (641) 939-8111
Fax (641) 939-8245
Hardin County Auditor's Office
Attn: Tina Schlemme
1215 Edgington Ave, Suite 1
Eldora, IA 50627

For Office Use Only

Approved: _____ Date: _____